

MODULE	m	16
NO. OF TEETH	z	160
PRES.ANGLE	$\alpha$	20°
PITCH DIA.		$\phi$ 2560
SHIFT	x	+0.5
ADDENDUM		22.4
DEDENDUM		12
GEAR ACCURACY		10FH (GB10095-88)
TOOTH THICKNESS	$W_{KEW}^{Em}$	915.16- <sup>-0.437</sup> <sub>-0.650</sub>
NO. OF THICKED TEETH	K	19

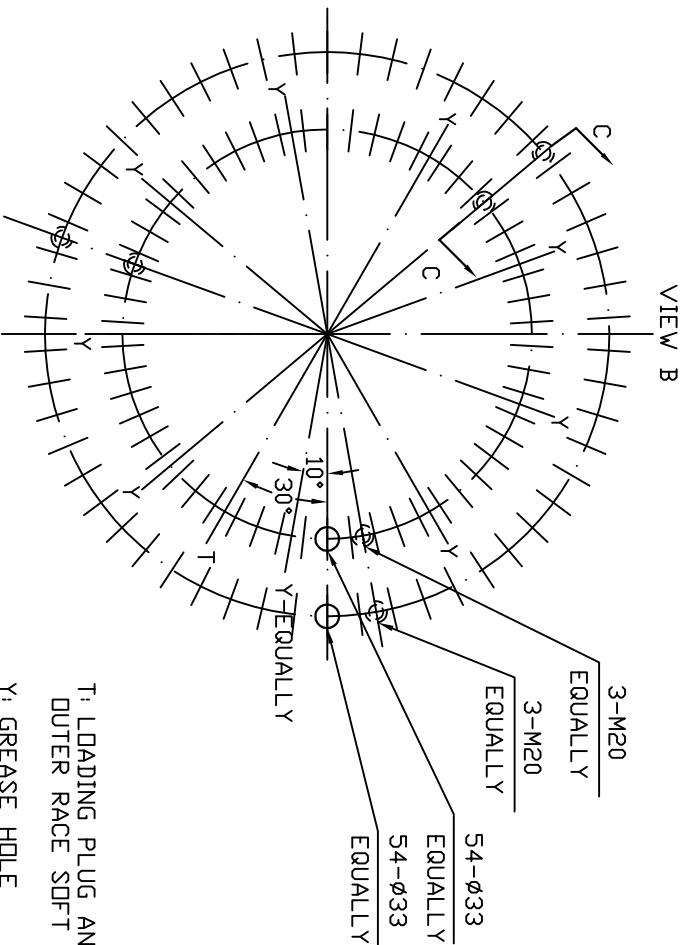
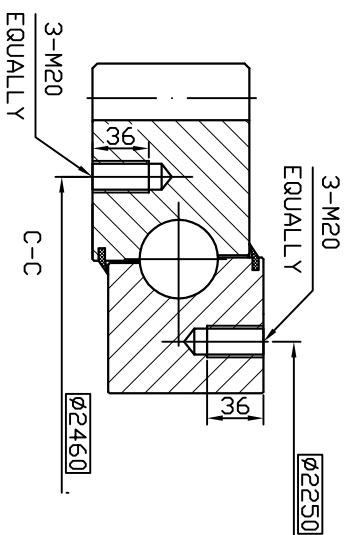

VIEW B

3-M20  
EQUALLY  
3-M20  
EQUALLY  
54- $\phi$ 33  
EQUALLY  
54- $\phi$ 33  
EQUALLY  
10°  
30°  
EQUALLY  
T: LOADING PLUG AND  
OUTER RACE SOFT ZONE  
Y: GREASE HOLE

Tolerance	0.5~3	3~6	6~30	>30~120	>120~400	>400~1000	>1000~2000
m	$\pm 0.1$	$\pm 0.1$	$\pm 0.2$	$\pm 0.3$	$\pm 0.5$	$\pm 0.8$	$\pm 1.2$
8	A-M10*1	GREASE	9				
7	$\phi$ 10*95	TAPER PIN	1				45
6	DS60*90	LOADING PLUG	1				50Mn
5		INNER RACE	1				42CrMo
4	MT17	SEAL	2				NBR
3	QG50	SEPARATOR	132				PA-1010
2	S $\phi$ 50.8	STEEL BALL	132				GCr15
1		OUTER RACE	1				42CrMo
NO.	REMARK	NAME OF PART	QUANTITY	MATERIAL			
APP.	2008.6.2						
CHK							
DWG.							
Sturm Praezision GmbH				SLEWING RING			
WEIGH SCALE				QWA2355.50			
1024kg				061.50.2355. 001.49.1504			